



# BERT HAANSTRAHOF 13

## ALMERE

Bieden vanaf **€ 825.000 K.K.**



# WELKOM BIJ BERT HAANSTRAHOF 13





# KENMERKEN

## Overdracht

Vraagprijs	€ 825.000,- k.k.
Aanvaarding	In overleg

## Bouw

Type object	Woonhuis, villa, vrijstaande woning, hofjeswoning
Soort bouw	Bestaande bouw
Bouwperiode	2000
Dakbedekking	Dakpannen
Type dak	Samengesteld
Keurmerken	Energie prestatie advies
Isolatievormen	Spouwmuren Volledig geïsoleerd

## Oppervlaktes en inhoud

Perceeloppervlakte	874 m <sup>2</sup>
Gebruiksoppervlakte wonen	157 m <sup>2</sup>
Inhoud	614 m <sup>3</sup>
Oppervlakte externe bergruimte	19 m <sup>2</sup>
Oppervlakte gebouwgebonden buitenruimte	2 m <sup>2</sup>

## Indeling

Aantal bouwlagen	3
Aantal kamers	5 (waarvan 4 slaapkamers)
Aantal badkamers	1
Aantal balkons	1

## Locatie

# KENMERKEN

Ligging	Aan park Aan rustige weg Beschutte ligging In woonwijk Nabij openbaar vervoer Nabij school Nabij snelweg Vrij uitzicht
---------	---

## Tuin

Type	Tuin rondom
Staat	Prachtig aangelegd

## Energieverbruik

Energielabel	A
--------------	---

## Uitrusting

Warm water	Stadsverwarming
Verwarmingssysteem	Airconditioning Stadsverwarming Vloerverwarming (gedeeltelijk) Zonnecollectoren
Heeft airco	Ja
Heeft een alarm	Ja
Heeft een balkon	Ja
Glasvezelaansluiting aanwezig	Ja
Tuin aanwezig	Ja
Heeft een sauna	Ja
Heeft schuur/berging	Ja
Heeft ventilatie	Ja

## Kadastrale gegevens

Eigendom	Eigen grond
----------	-------------



# KENMERKEN



**WOONOPPERVLAKTE**  
157m<sup>2</sup>

**PERCEELOPPERVLAKTE**  
874m<sup>2</sup>

**INHOUD**  
614m<sup>3</sup>

**BOUWJAAR**  
2000

**ENERGIELABEL**  
A



# OMSCHRIJVING

Rustiek wonen met een landelijk gevoel in het Almeerse!

Bert Haanstrahof 13, 1325 XB Filmwijk-Zuid Almere-Stad

Let op !! Deze woning wordt aangeboden met een "bieden vanaf" prijs van € 825.000,- k.k.

Zorgeloos vrijstaand wonen in het rustige "Parc Domenica". In tegenstelling tot andere villa wijken, waar vrijstaande woningen zijn gebouwd, zijn alle voorzieningen zoals winkels, scholen en het openbaar vervoer op loopafstand aanwezig. Het centrum van Almere-Stad (Almere City Mall) is met 10 fiets minuten te bereiken. Met de auto bent u razend snel op de A-6. Ondanks dat u midden in de stad woont zult u de ligging ervaren als een dorp in de stad. De gehele villa wijk is omzoomd met hoge hagen en heeft hierdoor een eigen unieke sfeer. Ontwerp De uitstraling van de villa's in Parc Domenica is on-Nederlands te noemen. De grote dakoverstekken en bij sommige type villa's de torens geven een Italiaanse uitstraling. Kenmerkend zijn ook de grote "lawns" voor de woningen. De voortuinen zijn volgens Amerikaans model aangelegd.

Indeling Begane grond:

kom je de woning binnen in de speelse hal. Hier tref je de meterkast (incl. aansluiting glasvezelnetwerk), de wasruimte, de keurige toiletruimte (vrijhangend closet), de toegang tot een slaap/werkkamer aan de achterzijde en de study (met bergvliering) met stromend water. Deze ruimte was voorheen in gebruik als garage en kan voor verschillende doeleinden gebruikt worden. Denk hierbij bijvoorbeeld aan een praktijk/kantoor aan huis, extra slaapkamer, speelkamer voor de kinderen of misschien een fitnessruimte?

De woonkamer is van een zeer ruim formaat. Maar ondanks de grootte is deze toch knus en gezellig ingericht met meerdere zithoeken. In het eetgedeelte met openslaande deuren, zijn rondom grote ramen geplaatst, wat voor een prettige natuurlijke lichtinval zorgt en een fraai uitzicht biedt op zowel de verzorgde achtertuin als de riante oprijlaan (ca. 25m!).

Grenzend aan de woonkamer tref je de half open

inbouwkeuken.

Deze is uitgevoerd met:

- lichte fronten en een lichtbruin gemêleerd natuurstenen werkblad
  - inductiekookplaat
  - 1 ½ spoelbak
  - RVS afzuigschouw combimagnetron (XL)
  - koel/vriescombinatie
  - aluminium schuifpui naar de achtertuin
- De royale verzorgde achtertuin heeft een mooie vijverpartij, een lounge zitgedeelte, diverse zonneterrassen, een grote vrijstaande houten berging en een vrijstaande houten relax-prieeltje achter in de tuin. Een knusse plek om je even terug te trekken.

Eerste verdieping:

2 relax-ligstoelen en de combinatie sauna (IR en stoom). De luxe badkamer is afgewerkt met wandbetegeling tot het plafond in lichte kleurstelling, wastafelmeubel met 2 wasbakken en een grote spiegel, een 2e vrijhangend toilet, een grote douche met regenkop, een designradiator en IR-verwarming aan het plafond.

Tweede verdieping:

toegang tot de riante 'torenkamer' met rondom ramen, airconditioning en een balkon.

Algemeen:

- Woonoppervlak: ca. 157m<sup>2</sup>, perceel: ca. 874m<sup>2</sup>, inhoud: ca. 614m<sup>3</sup>, bouwjaar: 2000;
- Royale oprijlaan van ca. 25m<sup>2</sup> en parkeren op eigen terrein (ca. 3 auto's);
- B.g.g. v.v. pvc vloer (visgraat/eiken met v.v. woonkamer). Nette laminaatvloer 1e en 2e ;
- Alle wanden netjes afgewerkt in lichte kleurstelling;
- Energielabel A en 12 zonnepanelen;
- Dichtbij scholen, gezondheidscentrum, treinstation, winkels en strand;
- Woning is uitermate geschikt te maken voor mantelzorg en/of als kangoeroewoning;
- Bieden vanaf: € 825.000,- k.k.;
- Oplevering in overleg, maar kan snel.
- Bezoek onze website of bel voor meer informatie-



Disclaimer:

Deze informatie is met de nodige zorgvuldigheid samengesteld. Onzekerheden worden echter geen enkele aansprakelijkheid aanvaard voor enige onvolledigheid, onjuistheid of anderszins, dan wel de gevolgen daarvan. Alle opgegeven maten en oppervlakten zijn indicatief. Wij staan dan ook niet in voor de juistheid en volledigheid van de getoonde informatie.

Van toepassing zijn de Vastgoed Nederland-voorwaarden.

English below

Rustic living with a rural feel in Almere!

Bert Haanstrahof 13, 1325 XB Filmwijk-Zuid Almere-Stad

Please note: This property is being offered with a starting bid price of €825,000 (costs payable by buyer).

Carefree detached living in the peaceful Parc Domenica. Unlike other villa neighbourhoods, where detached houses have been built, all amenities such as shops, schools and public transport are within walking distance. The centre of Almere-Stad (Almere City Mall) can be reached in 10 minutes by bike. By car, you can reach the A-6 motorway in no time. Even though you live in the middle of the city, you will experience the location as a village within the city. The entire villa neighbourhood is surrounded by high hedges, giving it its own unique atmosphere. Design The appearance of the villas in Parc Domenica is un-Dutch. The large roof overhangs and, in some types of villas, the towers give them an Italian look. Another characteristic feature are the large lawns in front of the houses. The front gardens are laid out according to the American model.

Layout Ground floor: The covered entrance leads into the playful hall. Here you will find the meter cupboard (including fibre optic network connection), the laundry room, the neat toilet (wall-mounted toilet), access to a bedroom/study at the rear and

the study (with storage loft) with running water. This space was previously used as a garage and can be used for various purposes. Think, for example, of a home office, extra bedroom, playroom for the children or perhaps a fitness room?

The living room is very spacious. But despite its size, it is cosy and comfortably furnished with several seating areas. In the dining area with French doors, large windows have been placed all around, providing pleasant natural light and a beautiful view of both the well-kept back garden and the spacious driveway (approx. 25m!).

Adjacent to the living room is the semi-open fitted kitchen. It is equipped with:

- light-coloured fronts and a light brown mottled natural stone worktop
- induction hob
- 1 ½ sink stainless steel extractor hood - combination microwave (XL)
- air conditioning
- fridge/freezer combination
- aluminium sliding doors to the back garden

The spacious, well-maintained back garden has a beautiful pond, a lounge seating area, various sun terraces, a large detached wooden shed and a detached wooden relaxation arbour at the back of the garden. A cosy place to retreat to.

First floor: Landing with wellness room including 2 relaxation chairs and combination sauna (IR and steam). The luxurious bathroom is finished with light-coloured wall tiles up to the ceiling, a washbasin unit with 2 sinks and a large mirror, a second free-hanging toilet, a large shower with rain shower head, a designer radiator and IR heating on the ceiling.

Second floor: Landing with third toilet and access to the spacious "tower room" with windows all around, air conditioning and a balcony.

General:

- Living area: approx. 157m<sup>2</sup>, plot: approx. 874m<sup>2</sup>, volume: approx. 614m<sup>3</sup>, year of construction: 2000;
- Spacious driveway of approx. 25m<sup>2</sup> and parking on own property (approx. 3 cars);
- Ground floor with PVC flooring (herringbone/oak with living room). Neat laminate flooring on 1st and 2nd floor;
- All walls neatly finished in light colours;















































# PLATTEGROND



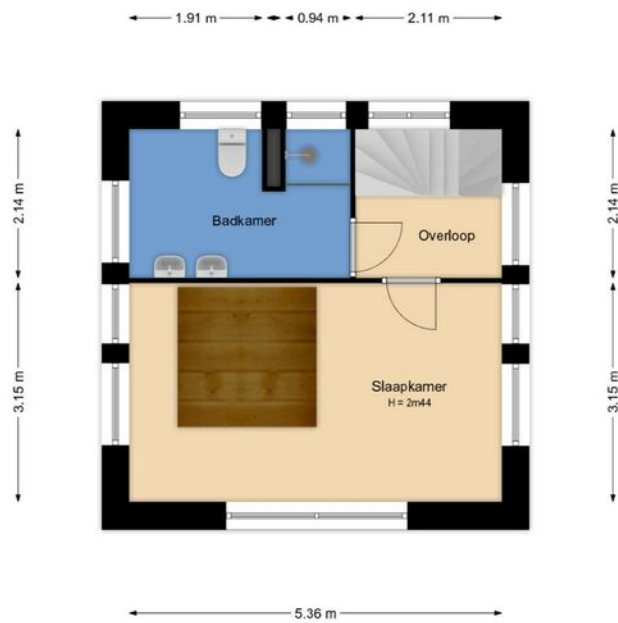

PLATTEGROND



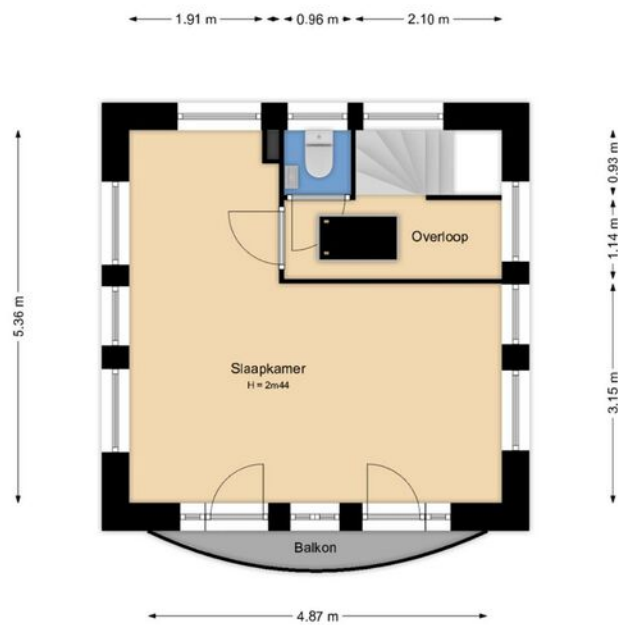

PLATTEGROND



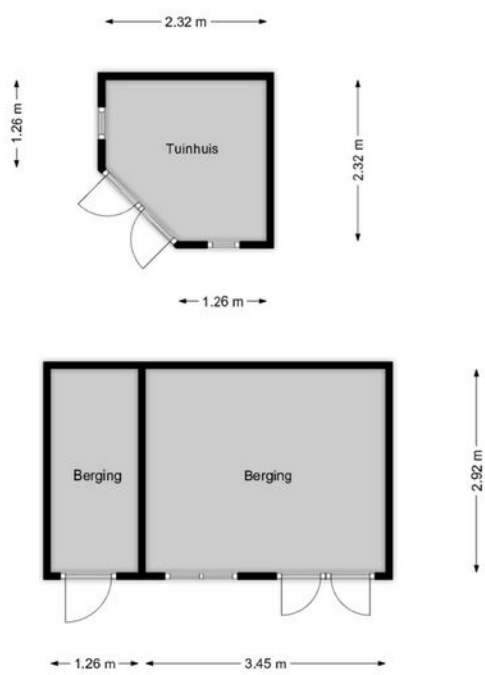

# PLATTEGROND





PLATTEGROND





PLATTEGROND





PLATTEGROND





PLATTEGROND



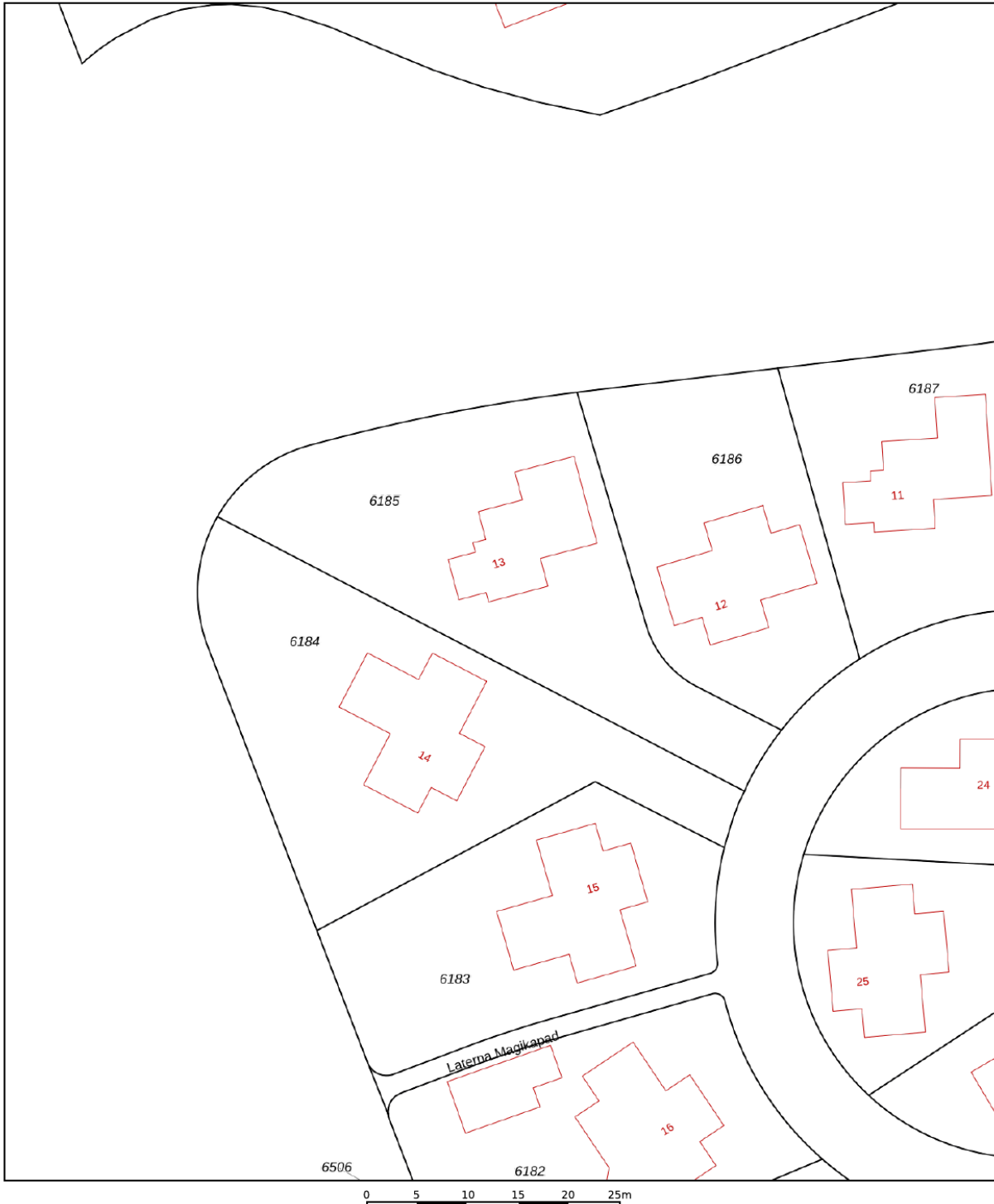

12345	Deze kaart is noordgericht	Schaal 1: 500	
25	Perceelnummer	Kadastrale gemeente Almere	
	Huisnummer	Sectie U	
—	Vastgestelde kadastrale grens	Perceel 6185	
—	Voorlopige kadastrale grens		
—	Administratieve kadastrale grens		
—	Bebouwing		

Voor een eensluitend uittreksel, geleverd op 14 juli 2025  
De bewaarder van het kadaster en de openbare registers

Aan dit uittreksel kunnen geen betrouwbare maten worden ontleend.  
De Dienst voor het kadaster en de openbare registers behoudt zich de intellectuele eigendomsrechten voor, waaronder het auteursrecht en het databankenrecht.

# KADASTRALE KAART

# LOCATIE OP DE KAART

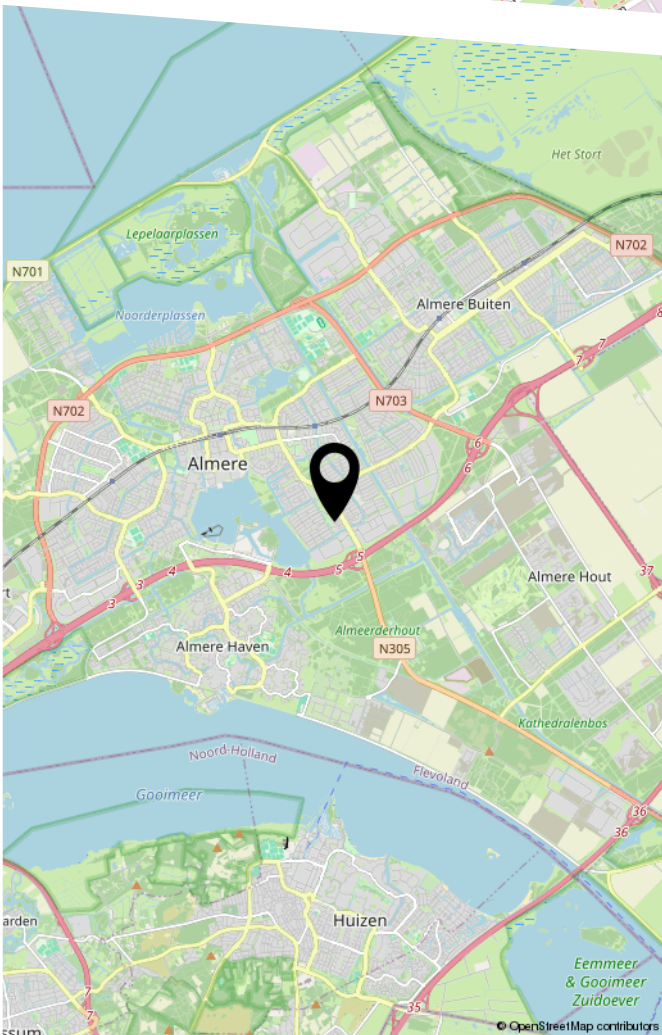
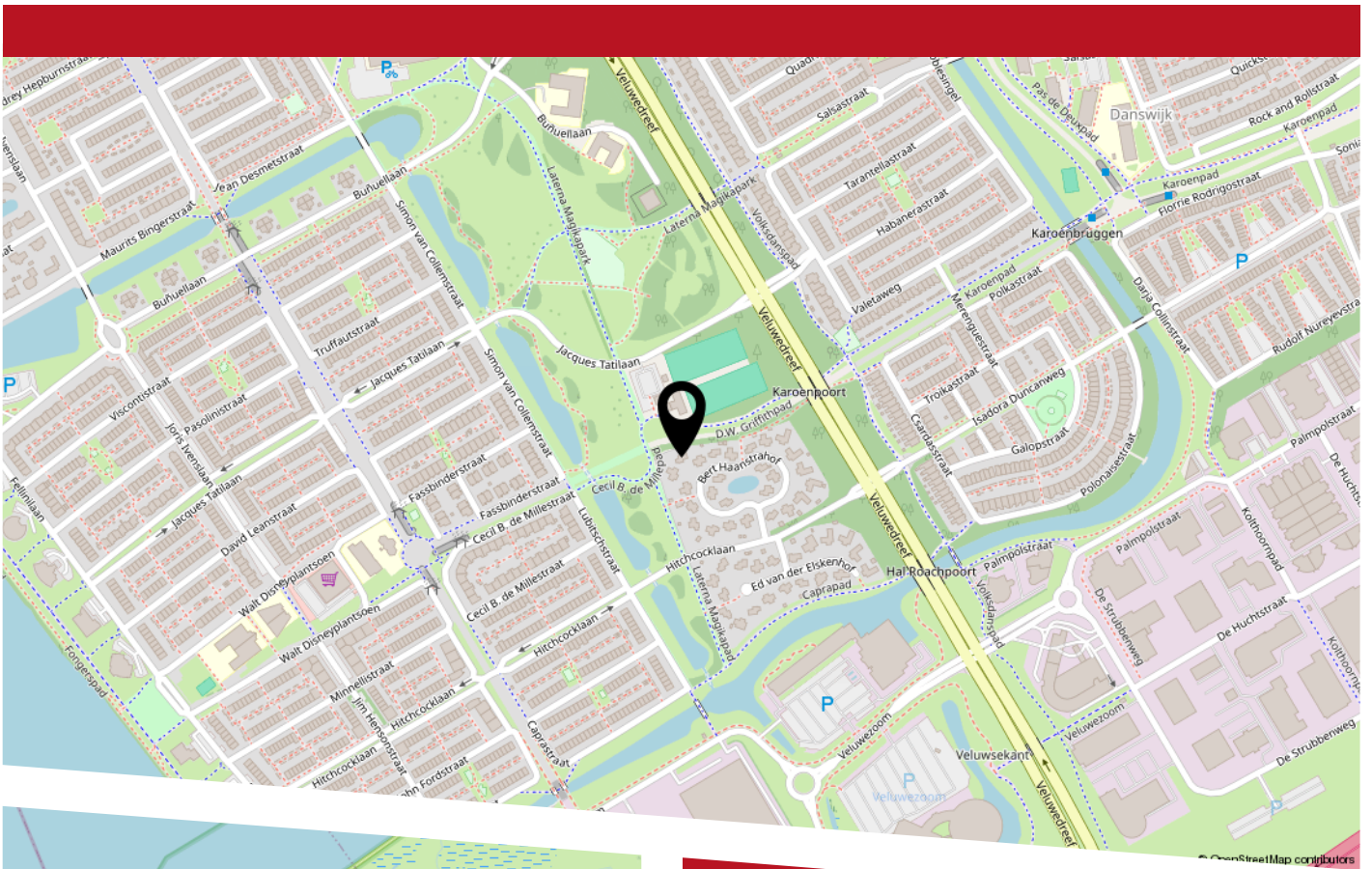



# Lijst van zaken



## Persoonlijke gegevens

Adres te verkopen woning:

Bert Haanstrahof 13, 1325 XB, Almere

Datum:

13-08-2025

Voor de onderstaande zaken -ongeacht of ze roerend dan wel onroerend zijn- geldt dat ze soms wel en soms niet in de woning achterblijven. De lijst is bedoeld om duidelijkheid te scheppen om discussies achteraf te voorkomen.

	Blijft achter	Gaat mee	Kan worden overgenomen	N.v.t.
<b>Woning</b>				
<i>Interieur</i>				
<b>Verlichting, te weten:</b>				
Inbouwspots / dimmers	<input type="checkbox"/>	<input type="checkbox"/>	<input type="checkbox"/>	<input checked="" type="checkbox"/>
Opbouwspots / armaturen / lampen / dimmers	<input checked="" type="checkbox"/>	<input type="checkbox"/>	<input type="checkbox"/>	<input type="checkbox"/>
Losse (hang)lampen	<input type="checkbox"/>	<input checked="" type="checkbox"/>	<input type="checkbox"/>	<input type="checkbox"/>
<b>(Losse) kasten, legplanken, te weten:</b>				
(Losse) kasten	<input type="checkbox"/>	<input type="checkbox"/>	<input checked="" type="checkbox"/>	<input type="checkbox"/>
Boeken / legplanken	<input checked="" type="checkbox"/>	<input type="checkbox"/>	<input type="checkbox"/>	<input type="checkbox"/>
<b>Raamdecoratie/zonwering binnen, te weten:</b>				
Gordijnrails	<input checked="" type="checkbox"/>	<input type="checkbox"/>	<input type="checkbox"/>	<input type="checkbox"/>
Gordijnen	<input checked="" type="checkbox"/>	<input type="checkbox"/>	<input type="checkbox"/>	<input type="checkbox"/>
Overgordijnen	<input checked="" type="checkbox"/>	<input type="checkbox"/>	<input type="checkbox"/>	<input type="checkbox"/>
Vitrages	<input checked="" type="checkbox"/>	<input type="checkbox"/>	<input type="checkbox"/>	<input type="checkbox"/>
Rolgordijnen	<input checked="" type="checkbox"/>	<input type="checkbox"/>	<input type="checkbox"/>	<input type="checkbox"/>
Lamellen	<input checked="" type="checkbox"/>	<input type="checkbox"/>	<input type="checkbox"/>	<input type="checkbox"/>
Jaloezieën	<input checked="" type="checkbox"/>	<input type="checkbox"/>	<input type="checkbox"/>	<input type="checkbox"/>
(Losse) horren / rolhorren	<input checked="" type="checkbox"/>	<input type="checkbox"/>	<input type="checkbox"/>	<input type="checkbox"/>

## Vloerdecoratie, te weten:

# Lijst van zaken

---

Vloerbedekking	<input type="checkbox"/>	<input type="checkbox"/>	<input type="checkbox"/>	<input checked="" type="checkbox"/>
----------------	--------------------------	--------------------------	--------------------------	-------------------------------------

---

Parketvloer	<input type="checkbox"/>	<input type="checkbox"/>	<input type="checkbox"/>	<input checked="" type="checkbox"/>
-------------	--------------------------	--------------------------	--------------------------	-------------------------------------

---

Houten vloer(delen)	<input type="checkbox"/>	<input type="checkbox"/>	<input type="checkbox"/>	<input checked="" type="checkbox"/>
---------------------	--------------------------	--------------------------	--------------------------	-------------------------------------

---

Laminaat	<input checked="" type="checkbox"/>	<input type="checkbox"/>	<input type="checkbox"/>	<input type="checkbox"/>
----------	-------------------------------------	--------------------------	--------------------------	--------------------------

---

Plavuizen	<input type="checkbox"/>	<input type="checkbox"/>	<input type="checkbox"/>	<input checked="" type="checkbox"/>
-----------	--------------------------	--------------------------	--------------------------	-------------------------------------

---

PVC vloer	<input checked="" type="checkbox"/>	<input type="checkbox"/>	<input type="checkbox"/>	<input type="checkbox"/>
-----------	-------------------------------------	--------------------------	--------------------------	--------------------------

---

## Open haard, kachel:

---

(Voorzet) openhaard met toebehoren	<input type="checkbox"/>	<input type="checkbox"/>	<input type="checkbox"/>	<input checked="" type="checkbox"/>
------------------------------------	--------------------------	--------------------------	--------------------------	-------------------------------------

---

Allesbrander	<input type="checkbox"/>	<input type="checkbox"/>	<input type="checkbox"/>	<input checked="" type="checkbox"/>
--------------	--------------------------	--------------------------	--------------------------	-------------------------------------

---

Houtkachel	<input type="checkbox"/>	<input type="checkbox"/>	<input type="checkbox"/>	<input checked="" type="checkbox"/>
------------	--------------------------	--------------------------	--------------------------	-------------------------------------

---

(Gas) kachels	<input type="checkbox"/>	<input type="checkbox"/>	<input type="checkbox"/>	<input checked="" type="checkbox"/>
---------------	--------------------------	--------------------------	--------------------------	-------------------------------------

---

Designradiator(en)	<input type="checkbox"/>	<input type="checkbox"/>	<input type="checkbox"/>	<input checked="" type="checkbox"/>
--------------------	--------------------------	--------------------------	--------------------------	-------------------------------------

---

Radiatorafwerking	<input type="checkbox"/>	<input type="checkbox"/>	<input type="checkbox"/>	<input checked="" type="checkbox"/>
-------------------	--------------------------	--------------------------	--------------------------	-------------------------------------

---

## Overige zaken, te weten:

---

Spiegelwanden	<input type="checkbox"/>	<input checked="" type="checkbox"/>	<input type="checkbox"/>	<input type="checkbox"/>
---------------	--------------------------	-------------------------------------	--------------------------	--------------------------

---

Schilderij ophang systeem	<input type="checkbox"/>	<input type="checkbox"/>	<input type="checkbox"/>	<input checked="" type="checkbox"/>
---------------------------	--------------------------	--------------------------	--------------------------	-------------------------------------

---

## Keuken

---

Keukenblok (met bovenkasten)	<input checked="" type="checkbox"/>	<input type="checkbox"/>	<input type="checkbox"/>	<input type="checkbox"/>
------------------------------	-------------------------------------	--------------------------	--------------------------	--------------------------

---

## Keuken (inbouw)apparatuur, te weten:

---

Kookplaat	<input checked="" type="checkbox"/>	<input type="checkbox"/>	<input type="checkbox"/>	<input type="checkbox"/>
-----------	-------------------------------------	--------------------------	--------------------------	--------------------------

---

(Gas) fornuis	<input type="checkbox"/>	<input type="checkbox"/>	<input type="checkbox"/>	<input checked="" type="checkbox"/>
---------------	--------------------------	--------------------------	--------------------------	-------------------------------------

---

Afzuigkap	<input checked="" type="checkbox"/>	<input type="checkbox"/>	<input type="checkbox"/>	<input type="checkbox"/>
-----------	-------------------------------------	--------------------------	--------------------------	--------------------------



# Lijst van zaken

Magnetron	<input checked="" type="checkbox"/>	<input type="checkbox"/>	<input type="checkbox"/>	<input type="checkbox"/>
Oven	<input type="checkbox"/>	<input type="checkbox"/>	<input type="checkbox"/>	<input checked="" type="checkbox"/>
Combi-oven / combi-magnetron	<input checked="" type="checkbox"/>	<input type="checkbox"/>	<input type="checkbox"/>	<input type="checkbox"/>
Koelkast	<input type="checkbox"/>	<input type="checkbox"/>	<input type="checkbox"/>	<input checked="" type="checkbox"/>
Vriezer	<input type="checkbox"/>	<input type="checkbox"/>	<input type="checkbox"/>	<input checked="" type="checkbox"/>
Koel-vriescombinatie	<input checked="" type="checkbox"/>	<input type="checkbox"/>	<input type="checkbox"/>	<input type="checkbox"/>
Vaatwasser	<input checked="" type="checkbox"/>	<input type="checkbox"/>	<input type="checkbox"/>	<input type="checkbox"/>
Quooker	<input type="checkbox"/>	<input type="checkbox"/>	<input type="checkbox"/>	<input checked="" type="checkbox"/>
Koffiezetapparaat	<input type="checkbox"/>	<input checked="" type="checkbox"/>	<input type="checkbox"/>	<input type="checkbox"/>

## Keukenaccessories, te weten:

Droogrek	<input type="checkbox"/>	<input type="checkbox"/>	<input type="checkbox"/>	<input checked="" type="checkbox"/>
----------	--------------------------	--------------------------	--------------------------	-------------------------------------

## Sanitair/sauna

### Toilet met de volgende toebehoren:

Toiletpot	<input checked="" type="checkbox"/>	<input type="checkbox"/>	<input type="checkbox"/>	<input type="checkbox"/>
Toiletrolhouder	<input checked="" type="checkbox"/>	<input type="checkbox"/>	<input type="checkbox"/>	<input type="checkbox"/>
Toiletborstel (houder)	<input checked="" type="checkbox"/>	<input type="checkbox"/>	<input type="checkbox"/>	<input type="checkbox"/>
Fontein	<input checked="" type="checkbox"/>	<input type="checkbox"/>	<input type="checkbox"/>	<input type="checkbox"/>

### Badkamer met de volgende toebehoren:

Ligbad	<input type="checkbox"/>	<input type="checkbox"/>	<input type="checkbox"/>	<input checked="" type="checkbox"/>
Jacuzzi / whirlpool	<input type="checkbox"/>	<input type="checkbox"/>	<input type="checkbox"/>	<input checked="" type="checkbox"/>
Douche (cabine / scherm)	<input checked="" type="checkbox"/>	<input type="checkbox"/>	<input type="checkbox"/>	<input type="checkbox"/>
Stoomdouche (cabine)	<input type="checkbox"/>	<input type="checkbox"/>	<input type="checkbox"/>	<input checked="" type="checkbox"/>

# Lijst van zaken

Wastafel	<input checked="" type="checkbox"/>	<input type="checkbox"/>	<input type="checkbox"/>	<input type="checkbox"/>
Wastafelmeubel	<input checked="" type="checkbox"/>	<input type="checkbox"/>	<input type="checkbox"/>	<input type="checkbox"/>
Planchet	<input type="checkbox"/>	<input type="checkbox"/>	<input type="checkbox"/>	<input checked="" type="checkbox"/>
Toiletkast	<input checked="" type="checkbox"/>	<input type="checkbox"/>	<input type="checkbox"/>	<input type="checkbox"/>
Toiletpot	<input checked="" type="checkbox"/>	<input type="checkbox"/>	<input type="checkbox"/>	<input type="checkbox"/>
Toiletrolhouder	<input checked="" type="checkbox"/>	<input type="checkbox"/>	<input type="checkbox"/>	<input type="checkbox"/>
Toiletborstel (houder)	<input type="checkbox"/>	<input checked="" type="checkbox"/>	<input type="checkbox"/>	<input type="checkbox"/>
Sauna met toebehoren	<input checked="" type="checkbox"/>	<input type="checkbox"/>	<input type="checkbox"/>	<input type="checkbox"/>

## *Exterieur/Installaties/Veiligheid/Energiebesparing*

Schotel / antenne	<input type="checkbox"/>	<input type="checkbox"/>	<input type="checkbox"/>	<input checked="" type="checkbox"/>
Brievenbus	<input checked="" type="checkbox"/>	<input type="checkbox"/>	<input type="checkbox"/>	<input type="checkbox"/>
Kluis	<input type="checkbox"/>	<input type="checkbox"/>	<input type="checkbox"/>	<input checked="" type="checkbox"/>
(Voordeur) bel	<input checked="" type="checkbox"/>	<input type="checkbox"/>	<input type="checkbox"/>	<input type="checkbox"/>
Alarminstallatie	<input checked="" type="checkbox"/>	<input type="checkbox"/>	<input type="checkbox"/>	<input type="checkbox"/>
(Veiligheids) sloten en overige inbraakpreventie	<input checked="" type="checkbox"/>	<input type="checkbox"/>	<input type="checkbox"/>	<input type="checkbox"/>
Rookmelders	<input checked="" type="checkbox"/>	<input type="checkbox"/>	<input type="checkbox"/>	<input type="checkbox"/>
(Klok) thermostaat	<input type="checkbox"/>	<input type="checkbox"/>	<input type="checkbox"/>	<input checked="" type="checkbox"/>
Airconditioning	<input checked="" type="checkbox"/>	<input type="checkbox"/>	<input type="checkbox"/>	<input type="checkbox"/>
Screens	<input type="checkbox"/>	<input type="checkbox"/>	<input type="checkbox"/>	<input checked="" type="checkbox"/>
Rolluiken	<input type="checkbox"/>	<input type="checkbox"/>	<input type="checkbox"/>	<input checked="" type="checkbox"/>
Zonwering buiten	<input type="checkbox"/>	<input type="checkbox"/>	<input type="checkbox"/>	<input checked="" type="checkbox"/>

**Warmwatervoorziening, te weten:**



# Lijst van zaken

CV-installatie	<input checked="" type="checkbox"/>	<input type="checkbox"/>	<input type="checkbox"/>	<input type="checkbox"/>
----------------	-------------------------------------	--------------------------	--------------------------	--------------------------

Boiler	<input type="checkbox"/>	<input type="checkbox"/>	<input type="checkbox"/>	<input checked="" type="checkbox"/>
--------	--------------------------	--------------------------	--------------------------	-------------------------------------

Geiser	<input type="checkbox"/>	<input type="checkbox"/>	<input type="checkbox"/>	<input checked="" type="checkbox"/>
--------	--------------------------	--------------------------	--------------------------	-------------------------------------

## Isolatievoorzieningen (voorzetramen/radiatorfolie etc.), te weten:

Voorzetramen	<input type="checkbox"/>	<input type="checkbox"/>	<input type="checkbox"/>	<input checked="" type="checkbox"/>
--------------	--------------------------	--------------------------	--------------------------	-------------------------------------

Radiatorfolie	<input type="checkbox"/>	<input type="checkbox"/>	<input type="checkbox"/>	<input checked="" type="checkbox"/>
---------------	--------------------------	--------------------------	--------------------------	-------------------------------------

## Overige zaken, te weten:

Telefoonaansluiting / internetaansluiting	<input checked="" type="checkbox"/>	<input type="checkbox"/>	<input type="checkbox"/>	<input type="checkbox"/>
---	-------------------------------------	--------------------------	--------------------------	--------------------------

Veiligheidsschakelaar wasautomaat	<input type="checkbox"/>	<input checked="" type="checkbox"/>	<input type="checkbox"/>	<input type="checkbox"/>
-----------------------------------	--------------------------	-------------------------------------	--------------------------	--------------------------

Waterslot wasautomaat	<input type="checkbox"/>	<input checked="" type="checkbox"/>	<input type="checkbox"/>	<input type="checkbox"/>
-----------------------	--------------------------	-------------------------------------	--------------------------	--------------------------

Zonnepanelen	<input checked="" type="checkbox"/>	<input type="checkbox"/>	<input type="checkbox"/>	<input type="checkbox"/>
--------------	-------------------------------------	--------------------------	--------------------------	--------------------------

Oplaadpunt elektrische auto	<input type="checkbox"/>	<input type="checkbox"/>	<input type="checkbox"/>	<input checked="" type="checkbox"/>
-----------------------------	--------------------------	--------------------------	--------------------------	-------------------------------------

## Tuin

### Inrichting

Tuinaanleg / bestrating	<input checked="" type="checkbox"/>	<input type="checkbox"/>	<input type="checkbox"/>	<input type="checkbox"/>
-------------------------	-------------------------------------	--------------------------	--------------------------	--------------------------

Beplanting	<input checked="" type="checkbox"/>	<input type="checkbox"/>	<input type="checkbox"/>	<input type="checkbox"/>
------------	-------------------------------------	--------------------------	--------------------------	--------------------------

### Verlichting/installaties

Buitenverlichting	<input checked="" type="checkbox"/>	<input type="checkbox"/>	<input type="checkbox"/>	<input type="checkbox"/>
-------------------	-------------------------------------	--------------------------	--------------------------	--------------------------

Tijd- of schemerschakelaar / bewegingsmelder	<input checked="" type="checkbox"/>	<input type="checkbox"/>	<input type="checkbox"/>	<input type="checkbox"/>
--	-------------------------------------	--------------------------	--------------------------	--------------------------

### Bebouwing

Tuinhuis / buitenberging	<input checked="" type="checkbox"/>	<input type="checkbox"/>	<input type="checkbox"/>	<input type="checkbox"/>
--------------------------	-------------------------------------	--------------------------	--------------------------	--------------------------

Kasten / werkbank in tuinhuis / berging	<input type="checkbox"/>	<input type="checkbox"/>	<input checked="" type="checkbox"/>	<input type="checkbox"/>
---	--------------------------	--------------------------	-------------------------------------	--------------------------

# Lijst van zaken

---

(Broei) kas	<input type="checkbox"/>	<input type="checkbox"/>	<input type="checkbox"/>	<input checked="" type="checkbox"/>
-------------	--------------------------	--------------------------	--------------------------	-------------------------------------

## Overige zaken

---

(Sier) hek	<input checked="" type="checkbox"/>	<input type="checkbox"/>	<input type="checkbox"/>	<input type="checkbox"/>
------------	-------------------------------------	--------------------------	--------------------------	--------------------------

---

Vlaggenmast (houder)	<input type="checkbox"/>	<input type="checkbox"/>	<input type="checkbox"/>	<input checked="" type="checkbox"/>
----------------------	--------------------------	--------------------------	--------------------------	-------------------------------------

## Overig

Zijn er zaken die geen eigendom zijn van verkoper omdat er sprake is van een leasecontract of huurcontract. Zo ja, neemt verkoper de zaak mee of wordt het betreffende contract overgenomen?

Ja      Nee      Gaat mee      Moet worden overgenomen

---

CV	<input type="checkbox"/>	<input checked="" type="checkbox"/>	<input type="checkbox"/>	<input type="checkbox"/>
----	--------------------------	-------------------------------------	--------------------------	--------------------------

---

Boiler	<input type="checkbox"/>	<input checked="" type="checkbox"/>	<input type="checkbox"/>	<input type="checkbox"/>
--------	--------------------------	-------------------------------------	--------------------------	--------------------------

---

Zonnepanelen	<input type="checkbox"/>	<input checked="" type="checkbox"/>	<input type="checkbox"/>	<input type="checkbox"/>
--------------	--------------------------	-------------------------------------	--------------------------	--------------------------

Voor akkoord,

De opdrachtgever/verkoper,  
(en echtgeno(o)t(e)/partner)

plaats en datum:

Koper,  
(en echtgeno(o)t(e)/partner)

plaats en datum:



# List of goods



## Personal details

Address of house to be sold:

Bert Haanstrahof 13, 1325 XB, Almere

date:

13-08-2025

For the items below -regardless of whether they are movable or immovable- they sometimes remain in the home and sometimes not. The list is intended to create clarity in order to avoid discussions afterwards.

	Stays behind	Coming with	Can be acquired	N/A
<b>House</b>				
<i>Interior</i>				
<b>Lighting, namely:</b>				
Recessed spotlights / dimmers	<input type="checkbox"/>	<input type="checkbox"/>	<input type="checkbox"/>	<input checked="" type="checkbox"/>
Surface mounted spots / fixtures / lamps / dimmers	<input checked="" type="checkbox"/>	<input type="checkbox"/>	<input type="checkbox"/>	<input type="checkbox"/>
Loose (hanging) lamps	<input type="checkbox"/>	<input checked="" type="checkbox"/>	<input type="checkbox"/>	<input type="checkbox"/>
<b>(Seperate) cabinets, shelves, namely:</b>				
(Seperate) cabinets	<input type="checkbox"/>	<input type="checkbox"/>	<input checked="" type="checkbox"/>	<input type="checkbox"/>
Books / shelves	<input checked="" type="checkbox"/>	<input type="checkbox"/>	<input type="checkbox"/>	<input type="checkbox"/>
<b>Window decoration / blinds inside, namely:</b>				
Curtain rails	<input checked="" type="checkbox"/>	<input type="checkbox"/>	<input type="checkbox"/>	<input type="checkbox"/>
Curtains	<input checked="" type="checkbox"/>	<input type="checkbox"/>	<input type="checkbox"/>	<input type="checkbox"/>
Drapes	<input checked="" type="checkbox"/>	<input type="checkbox"/>	<input type="checkbox"/>	<input type="checkbox"/>
Net curtains	<input checked="" type="checkbox"/>	<input type="checkbox"/>	<input type="checkbox"/>	<input type="checkbox"/>
Roller blinds	<input checked="" type="checkbox"/>	<input type="checkbox"/>	<input type="checkbox"/>	<input type="checkbox"/>
Slats	<input checked="" type="checkbox"/>	<input type="checkbox"/>	<input type="checkbox"/>	<input type="checkbox"/>
Blinds	<input checked="" type="checkbox"/>	<input type="checkbox"/>	<input type="checkbox"/>	<input type="checkbox"/>
(Separate) fly screens / roller fly screens	<input checked="" type="checkbox"/>	<input type="checkbox"/>	<input type="checkbox"/>	<input type="checkbox"/>

## Floor decoration, namely:

# List of goods

---

Carpeting	<input type="checkbox"/>	<input type="checkbox"/>	<input type="checkbox"/>	<input checked="" type="checkbox"/>
-----------	--------------------------	--------------------------	--------------------------	-------------------------------------

---

Parquet floor	<input type="checkbox"/>	<input type="checkbox"/>	<input type="checkbox"/>	<input checked="" type="checkbox"/>
---------------	--------------------------	--------------------------	--------------------------	-------------------------------------

---

Wooden floor(parts)	<input type="checkbox"/>	<input type="checkbox"/>	<input type="checkbox"/>	<input checked="" type="checkbox"/>
---------------------	--------------------------	--------------------------	--------------------------	-------------------------------------

---

Laminate flooring	<input checked="" type="checkbox"/>	<input type="checkbox"/>	<input type="checkbox"/>	<input type="checkbox"/>
-------------------	-------------------------------------	--------------------------	--------------------------	--------------------------

---

Tiles	<input type="checkbox"/>	<input type="checkbox"/>	<input type="checkbox"/>	<input checked="" type="checkbox"/>
-------	--------------------------	--------------------------	--------------------------	-------------------------------------

---

PVC vloer	<input checked="" type="checkbox"/>	<input type="checkbox"/>	<input type="checkbox"/>	<input type="checkbox"/>
-----------	-------------------------------------	--------------------------	--------------------------	--------------------------

---

## Fireplace, stove:

---

(Front) fireplace with accessories	<input type="checkbox"/>	<input type="checkbox"/>	<input type="checkbox"/>	<input checked="" type="checkbox"/>
------------------------------------	--------------------------	--------------------------	--------------------------	-------------------------------------

---

Wood burner	<input type="checkbox"/>	<input type="checkbox"/>	<input type="checkbox"/>	<input checked="" type="checkbox"/>
-------------	--------------------------	--------------------------	--------------------------	-------------------------------------

---

Wood stove	<input type="checkbox"/>	<input type="checkbox"/>	<input type="checkbox"/>	<input checked="" type="checkbox"/>
------------	--------------------------	--------------------------	--------------------------	-------------------------------------

---

(Gas) heaters	<input type="checkbox"/>	<input type="checkbox"/>	<input type="checkbox"/>	<input checked="" type="checkbox"/>
---------------	--------------------------	--------------------------	--------------------------	-------------------------------------

---

Designer radiator(s)	<input type="checkbox"/>	<input type="checkbox"/>	<input type="checkbox"/>	<input checked="" type="checkbox"/>
----------------------	--------------------------	--------------------------	--------------------------	-------------------------------------

---

Radiator finish	<input type="checkbox"/>	<input type="checkbox"/>	<input type="checkbox"/>	<input checked="" type="checkbox"/>
-----------------	--------------------------	--------------------------	--------------------------	-------------------------------------

---

## Other interior, namely:

---

Mirror walls	<input type="checkbox"/>	<input checked="" type="checkbox"/>	<input type="checkbox"/>	<input type="checkbox"/>
--------------	--------------------------	-------------------------------------	--------------------------	--------------------------

---

Picture hanging system	<input type="checkbox"/>	<input type="checkbox"/>	<input type="checkbox"/>	<input checked="" type="checkbox"/>
------------------------	--------------------------	--------------------------	--------------------------	-------------------------------------

---

## *Kitchen*

---

Kitchen unit (with upper cabinets)	<input checked="" type="checkbox"/>	<input type="checkbox"/>	<input type="checkbox"/>	<input type="checkbox"/>
------------------------------------	-------------------------------------	--------------------------	--------------------------	--------------------------

---

## Kitchen (built-in) equipment, namely:

---

Cooker	<input checked="" type="checkbox"/>	<input type="checkbox"/>	<input type="checkbox"/>	<input type="checkbox"/>
--------	-------------------------------------	--------------------------	--------------------------	--------------------------

---

Stove	<input type="checkbox"/>	<input type="checkbox"/>	<input type="checkbox"/>	<input checked="" type="checkbox"/>
-------	--------------------------	--------------------------	--------------------------	-------------------------------------

---

Extractor hood	<input checked="" type="checkbox"/>	<input type="checkbox"/>	<input type="checkbox"/>	<input type="checkbox"/>
----------------	-------------------------------------	--------------------------	--------------------------	--------------------------



# List of goods

Microwave	<input checked="" type="checkbox"/>	<input type="checkbox"/>	<input type="checkbox"/>	<input type="checkbox"/>
Oven	<input type="checkbox"/>	<input type="checkbox"/>	<input type="checkbox"/>	<input checked="" type="checkbox"/>
Combi oven / combi microwave	<input checked="" type="checkbox"/>	<input type="checkbox"/>	<input type="checkbox"/>	<input type="checkbox"/>
Refrigerator	<input type="checkbox"/>	<input type="checkbox"/>	<input type="checkbox"/>	<input checked="" type="checkbox"/>
Freezer	<input type="checkbox"/>	<input type="checkbox"/>	<input type="checkbox"/>	<input checked="" type="checkbox"/>
Refrigerator with freezer	<input checked="" type="checkbox"/>	<input type="checkbox"/>	<input type="checkbox"/>	<input type="checkbox"/>
Dishwasher	<input checked="" type="checkbox"/>	<input type="checkbox"/>	<input type="checkbox"/>	<input type="checkbox"/>
Quooker	<input type="checkbox"/>	<input type="checkbox"/>	<input type="checkbox"/>	<input checked="" type="checkbox"/>
Coffee machine	<input type="checkbox"/>	<input checked="" type="checkbox"/>	<input type="checkbox"/>	<input type="checkbox"/>

## Kitchen accessories, namely:

Drying rack	<input type="checkbox"/>	<input type="checkbox"/>	<input type="checkbox"/>	<input checked="" type="checkbox"/>
-------------	--------------------------	--------------------------	--------------------------	-------------------------------------

## Sanitary/sauna

### Toilet with the following accessories:

Toilet bowl	<input checked="" type="checkbox"/>	<input type="checkbox"/>	<input type="checkbox"/>	<input type="checkbox"/>
Toilet roll holder	<input checked="" type="checkbox"/>	<input type="checkbox"/>	<input type="checkbox"/>	<input type="checkbox"/>
Toilet brush (holder)	<input checked="" type="checkbox"/>	<input type="checkbox"/>	<input type="checkbox"/>	<input type="checkbox"/>
Fountain	<input checked="" type="checkbox"/>	<input type="checkbox"/>	<input type="checkbox"/>	<input type="checkbox"/>

### Bathroom with the following accessories:

Bathtub	<input type="checkbox"/>	<input type="checkbox"/>	<input type="checkbox"/>	<input checked="" type="checkbox"/>
Jacuzzi / whirlpool	<input type="checkbox"/>	<input type="checkbox"/>	<input type="checkbox"/>	<input checked="" type="checkbox"/>
Shower (cabin / screen)	<input checked="" type="checkbox"/>	<input type="checkbox"/>	<input type="checkbox"/>	<input type="checkbox"/>
Steam shower (cabin)	<input type="checkbox"/>	<input type="checkbox"/>	<input type="checkbox"/>	<input checked="" type="checkbox"/>

# List of goods

Sink	<input checked="" type="checkbox"/>	<input type="checkbox"/>	<input type="checkbox"/>	<input type="checkbox"/>
Sink furniture	<input checked="" type="checkbox"/>	<input type="checkbox"/>	<input type="checkbox"/>	<input type="checkbox"/>
Shelf	<input type="checkbox"/>	<input type="checkbox"/>	<input type="checkbox"/>	<input checked="" type="checkbox"/>
Toilet closet	<input checked="" type="checkbox"/>	<input type="checkbox"/>	<input type="checkbox"/>	<input type="checkbox"/>
Toilet bowl	<input checked="" type="checkbox"/>	<input type="checkbox"/>	<input type="checkbox"/>	<input type="checkbox"/>
Toilet roll holder	<input checked="" type="checkbox"/>	<input type="checkbox"/>	<input type="checkbox"/>	<input type="checkbox"/>
Toilet brush (holder)	<input type="checkbox"/>	<input checked="" type="checkbox"/>	<input type="checkbox"/>	<input type="checkbox"/>
Sauna	<input checked="" type="checkbox"/>	<input type="checkbox"/>	<input type="checkbox"/>	<input type="checkbox"/>

## *Exterior/Installations/Security/Energy saving*

Dish / antenna	<input type="checkbox"/>	<input type="checkbox"/>	<input type="checkbox"/>	<input checked="" type="checkbox"/>
Letter box	<input checked="" type="checkbox"/>	<input type="checkbox"/>	<input type="checkbox"/>	<input type="checkbox"/>
Vault	<input type="checkbox"/>	<input type="checkbox"/>	<input type="checkbox"/>	<input checked="" type="checkbox"/>
(Front door) bell	<input checked="" type="checkbox"/>	<input type="checkbox"/>	<input type="checkbox"/>	<input type="checkbox"/>
Alarm system	<input checked="" type="checkbox"/>	<input type="checkbox"/>	<input type="checkbox"/>	<input type="checkbox"/>
(Security) locks and other burglary prevention	<input checked="" type="checkbox"/>	<input type="checkbox"/>	<input type="checkbox"/>	<input type="checkbox"/>
Smoke detectors	<input checked="" type="checkbox"/>	<input type="checkbox"/>	<input type="checkbox"/>	<input type="checkbox"/>
(Clock) thermostat	<input type="checkbox"/>	<input type="checkbox"/>	<input type="checkbox"/>	<input checked="" type="checkbox"/>
Airconditioning	<input checked="" type="checkbox"/>	<input type="checkbox"/>	<input type="checkbox"/>	<input type="checkbox"/>
Screens	<input type="checkbox"/>	<input type="checkbox"/>	<input type="checkbox"/>	<input checked="" type="checkbox"/>
Rolling shutter(s)	<input type="checkbox"/>	<input type="checkbox"/>	<input type="checkbox"/>	<input checked="" type="checkbox"/>
Sun protection outside	<input type="checkbox"/>	<input type="checkbox"/>	<input type="checkbox"/>	<input checked="" type="checkbox"/>

**Hot water supply, namely:**



# List of goods

---

Central heating system	<input checked="" type="checkbox"/>	<input type="checkbox"/>	<input type="checkbox"/>	<input type="checkbox"/>
------------------------	-------------------------------------	--------------------------	--------------------------	--------------------------

---

Boiler	<input type="checkbox"/>	<input type="checkbox"/>	<input type="checkbox"/>	<input checked="" type="checkbox"/>
--------	--------------------------	--------------------------	--------------------------	-------------------------------------

---

Heater	<input type="checkbox"/>	<input type="checkbox"/>	<input type="checkbox"/>	<input checked="" type="checkbox"/>
--------	--------------------------	--------------------------	--------------------------	-------------------------------------

---

## Insulation facilities (additional windows/radiator foil, etc.), namely:

---

Additional windows	<input type="checkbox"/>	<input type="checkbox"/>	<input type="checkbox"/>	<input checked="" type="checkbox"/>
--------------------	--------------------------	--------------------------	--------------------------	-------------------------------------

---

Radiator foil	<input type="checkbox"/>	<input type="checkbox"/>	<input type="checkbox"/>	<input checked="" type="checkbox"/>
---------------	--------------------------	--------------------------	--------------------------	-------------------------------------

---

## Other matters, namely:

---

Telephone connection / internet connection	<input checked="" type="checkbox"/>	<input type="checkbox"/>	<input type="checkbox"/>	<input type="checkbox"/>
--	-------------------------------------	--------------------------	--------------------------	--------------------------

---

Washing machine safety switch	<input type="checkbox"/>	<input checked="" type="checkbox"/>	<input type="checkbox"/>	<input type="checkbox"/>
-------------------------------	--------------------------	-------------------------------------	--------------------------	--------------------------

---

Water seal washing machine	<input type="checkbox"/>	<input checked="" type="checkbox"/>	<input type="checkbox"/>	<input type="checkbox"/>
----------------------------	--------------------------	-------------------------------------	--------------------------	--------------------------

---

Solar panels	<input checked="" type="checkbox"/>	<input type="checkbox"/>	<input type="checkbox"/>	<input type="checkbox"/>
--------------	-------------------------------------	--------------------------	--------------------------	--------------------------

---

Electric car charging point	<input type="checkbox"/>	<input type="checkbox"/>	<input type="checkbox"/>	<input checked="" type="checkbox"/>
-----------------------------	--------------------------	--------------------------	--------------------------	-------------------------------------

## Garden

### *Garden decor*

---

Garden landscaping / paving	<input checked="" type="checkbox"/>	<input type="checkbox"/>	<input type="checkbox"/>	<input type="checkbox"/>
-----------------------------	-------------------------------------	--------------------------	--------------------------	--------------------------

---

Planting	<input checked="" type="checkbox"/>	<input type="checkbox"/>	<input type="checkbox"/>	<input type="checkbox"/>
----------	-------------------------------------	--------------------------	--------------------------	--------------------------

### *Garden lighting/installations*

---

Outdoor lighting	<input checked="" type="checkbox"/>	<input type="checkbox"/>	<input type="checkbox"/>	<input type="checkbox"/>
------------------	-------------------------------------	--------------------------	--------------------------	--------------------------

---

Time or twilight switch / motion detector	<input checked="" type="checkbox"/>	<input type="checkbox"/>	<input type="checkbox"/>	<input type="checkbox"/>
---	-------------------------------------	--------------------------	--------------------------	--------------------------

### *Garden building*

---

Garden house / outdoor storage	<input checked="" type="checkbox"/>	<input type="checkbox"/>	<input type="checkbox"/>	<input type="checkbox"/>
--------------------------------	-------------------------------------	--------------------------	--------------------------	--------------------------

---

Cabinets / workbench in garden house / storage room	<input type="checkbox"/>	<input type="checkbox"/>	<input checked="" type="checkbox"/>	<input type="checkbox"/>
---	--------------------------	--------------------------	-------------------------------------	--------------------------

# List of goods

---

Greenhouse	<input type="checkbox"/>	<input type="checkbox"/>	<input type="checkbox"/>	<input checked="" type="checkbox"/>
------------	--------------------------	--------------------------	--------------------------	-------------------------------------

## Other matters

---

(Ornamental) fence	<input checked="" type="checkbox"/>	<input type="checkbox"/>	<input type="checkbox"/>	<input type="checkbox"/>
--------------------	-------------------------------------	--------------------------	--------------------------	--------------------------

---

Flagpole (holder)	<input type="checkbox"/>	<input type="checkbox"/>	<input type="checkbox"/>	<input checked="" type="checkbox"/>
-------------------	--------------------------	--------------------------	--------------------------	-------------------------------------

## Other

Are there items that are not the property of the seller because there is a lease or rental contract. If so, does the seller take over the item or will the relevant contract be taken over?

	Yes	No	Comin g with	Must be acquired
--	-----	----	-----------------	---------------------

---

Central heating	<input type="checkbox"/>	<input checked="" type="checkbox"/>	<input type="checkbox"/>	<input type="checkbox"/>
-----------------	--------------------------	-------------------------------------	--------------------------	--------------------------

---

Boiler	<input type="checkbox"/>	<input checked="" type="checkbox"/>	<input type="checkbox"/>	<input type="checkbox"/>
--------	--------------------------	-------------------------------------	--------------------------	--------------------------

---

Solar panels	<input type="checkbox"/>	<input checked="" type="checkbox"/>	<input type="checkbox"/>	<input type="checkbox"/>
--------------	--------------------------	-------------------------------------	--------------------------	--------------------------

For agreement,

The client/seller,  
(and spouse/partner)

location and date:

Buyer,  
(and spouse/partner)

location and date:





VBO  MAKELAAR

HEEFT U INTERESSE  
IN DEZE WONING?

**NEEM DAN CONTACT MET ONS OP!**

SIMON MAKELAARDIJ B.V.  
Microfoonstraat 74  
1322 BN, Almere

036-7634346  
[info@simonmakelaardij.nl](mailto:info@simonmakelaardij.nl)  
[simonmakelaardij.nl/](http://simonmakelaardij.nl/)